



# Cape Lookout



## CAMPGROUND

**Reserve early!** Reserve campsites, yurts, and cabins one day to nine months in advance by calling 1-800-452-5687 or visiting [www.oregonstateparks.org](http://www.oregonstateparks.org).

Nestled in a lush coastal forest on a sand spit between the Pacific Ocean and Netarts Bay, Cape Lookout State Park is a destination for sightseers, hikers, beachcombers, and campers who appreciate a harmonious blend of nature and recreation.

### Year-round Camping

- 38 full-hookup sites (sewer, electricity, water)
- 170 tent sites with water nearby
- 1 electrical site with water
- 13 yurts (six pet-friendly)
- 6 deluxe cabins (three pet-friendly)
- Paved parking, picnic table, and fire rings at all sites
- 2 group tent camping areas
- Hiker/biker camp
- Meeting hall
- Hot showers and flush toilets
- Firewood for sale
- RV dump station (located near the entrance to the campground; closed in winter)

### Universal Access

Two campsites (C35 and C37) and one cabin (Tillamook) are accessible to campers with disabilities. Nine yurts (C38, C40, C41, C43, C44, C46, C48, C50, and C52) and one cabin (Cape Meares) have ramp access but are not ADA-compliant.

### Camping Rates

Rates are subject to change. You can get up-to-date information by calling 1-800-551-6949 or visiting [www.oregonstateparks.org](http://www.oregonstateparks.org).

### Day-use Area Parking Fees

Cape Lookout requires a day-use parking permit year-round. You'll need to display either a daily permit, an annual or 24-month permit, an Oregon Pacific Coast Passport, or your camping receipt. Permits are sold at the park and online at [store.oregonstateparks.org](http://store.oregonstateparks.org). Your camping receipt serves as a daily permit for each day you are registered.

Smoking in Oregon State Parks is allowed only in personal vehicles, RVs, campsites and portions of day use parks along state highways that are designated as safety rest areas by the Oregon Department of Transportation.

**Need to cancel** your reservation? Follow these guidelines: If your reservation is for today, call 503-842-4981. Otherwise, call 1-800-452-5687.

### Yurt and Cabin Comforts

Enjoy the year-round comforts of a yurt or deluxe cabin. Yurts are domed tents with structural support, wooden floors, lockable doors, lights, heating, and beds with vinyl-covered mattresses. A bunk bed sleeps three, and a futon couch sleeps two. Our deluxe cabins, which also accommodate five, have refrigerators, microwave ovens, barbecue grills, TVs with DVD players, and bathrooms with showers. They are located next to the day-use area. All cabin and yurt sites have fire rings and picnic tables. Up to two pets (cats and/or dogs only) are allowed in designated pet-friendly facilities for an additional fee.

### Miles of Hiking Trails

The Cape Trail, a 5-mile round-trip trek to the tip of Cape Lookout, begins at the trailhead parking area 2.6 miles south of the park entrance on the Three Capes Scenic Route. The tip of the cape offers prime whale watching during Gray whale migrations.

The South Trail winds 1.8 miles from the trailhead to the beach south of the cape, and the North Trail extends 2.3 miles north to the park's day-use area.

A quarter-mile, self-guided nature trail departs from near the campground registration booth or the day-use area.

Trail guides are available at the registration booth or can be obtained from a park host.

### Three Capes Scenic Route

The northern end of this loop begins in Tillamook and winds along the shore of Tillamook Bay to Cape Lookout and two other capes with state parks. **Cape Meares State Scenic Viewpoint**, north of Cape Lookout, features a historic lighthouse, hiking trails, picnic areas, whale watching, an unusually shaped Sitka Spruce known as the "Octopus Tree," and the "Big Spruce," which is the largest Sitka Spruce in Oregon. The lighthouse is open daily depending on volunteer staffing and weather conditions.

Continuing south, **Oceanside Beach State Recreation Site** offers beach access north of Netarts Bay.

South of Cape Lookout, **Clay Myers State Natural Area** at Whalen Island is an ecological wonderland centered in the Sandlake Estuary. You can tour the island on a 1.4-mile loop trail.

### Park Information:

1-800-551-6949  
[www.oregonstateparks.org](http://www.oregonstateparks.org)

63400-8231 (4/17)

Located at the north end of Pacific City is **Cape Kiwanda State Natural Area**. Its sculpted sandstone cliffs provide a picturesque location for wave watching.

Pacific City is home to a dory fleet and is the location of **Bob Straub State Park**, which provides access to the broad, sandy beaches of the Nestucca Spit.

Further inland, 6 miles south of Tillamook off of Hwy. 101, **Munson Creek Falls State Natural Site** has a short trail to a viewpoint overlooking the highest waterfall (319 ft.) in the Coast mountain range.

Support your parks by becoming a member of the Oregon State Parks Foundation. Free 12-month day-use parking permit with your membership. [oregonstateparksfoundation.org](http://oregonstateparksfoundation.org).

 Western snowy plovers nest along some parts of the Oregon coast. Watch for special signs during nesting season.

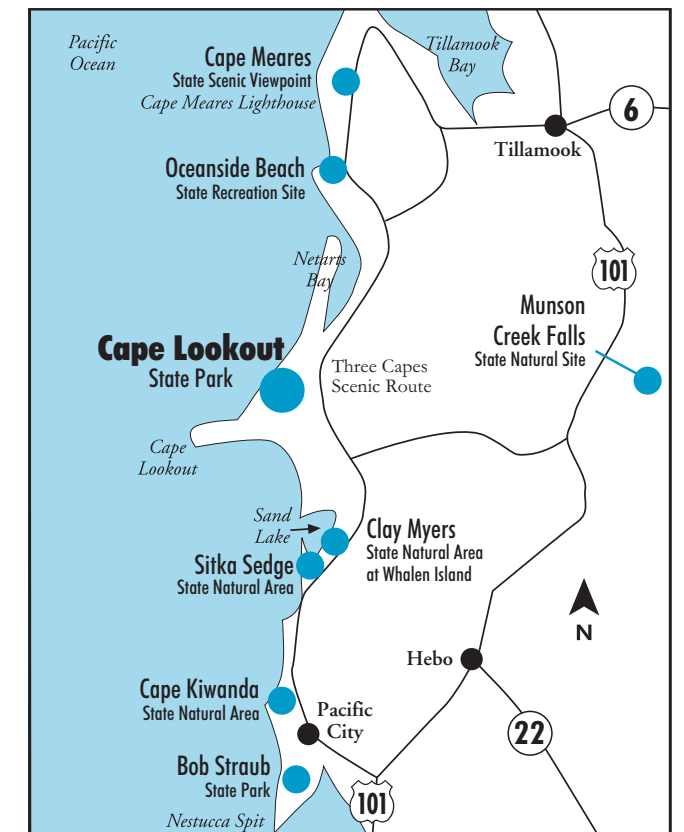

## Cape Lookout State Park

Off US 101, 11 miles SW of Tillamook  
13000 Whiskey Creek Rd W, Tillamook, OR 97141  
503-842-4981 or 503-842-3182



Latitude: 45.36682 N  
Longitude: -123.962148 W

# Cape Lookout

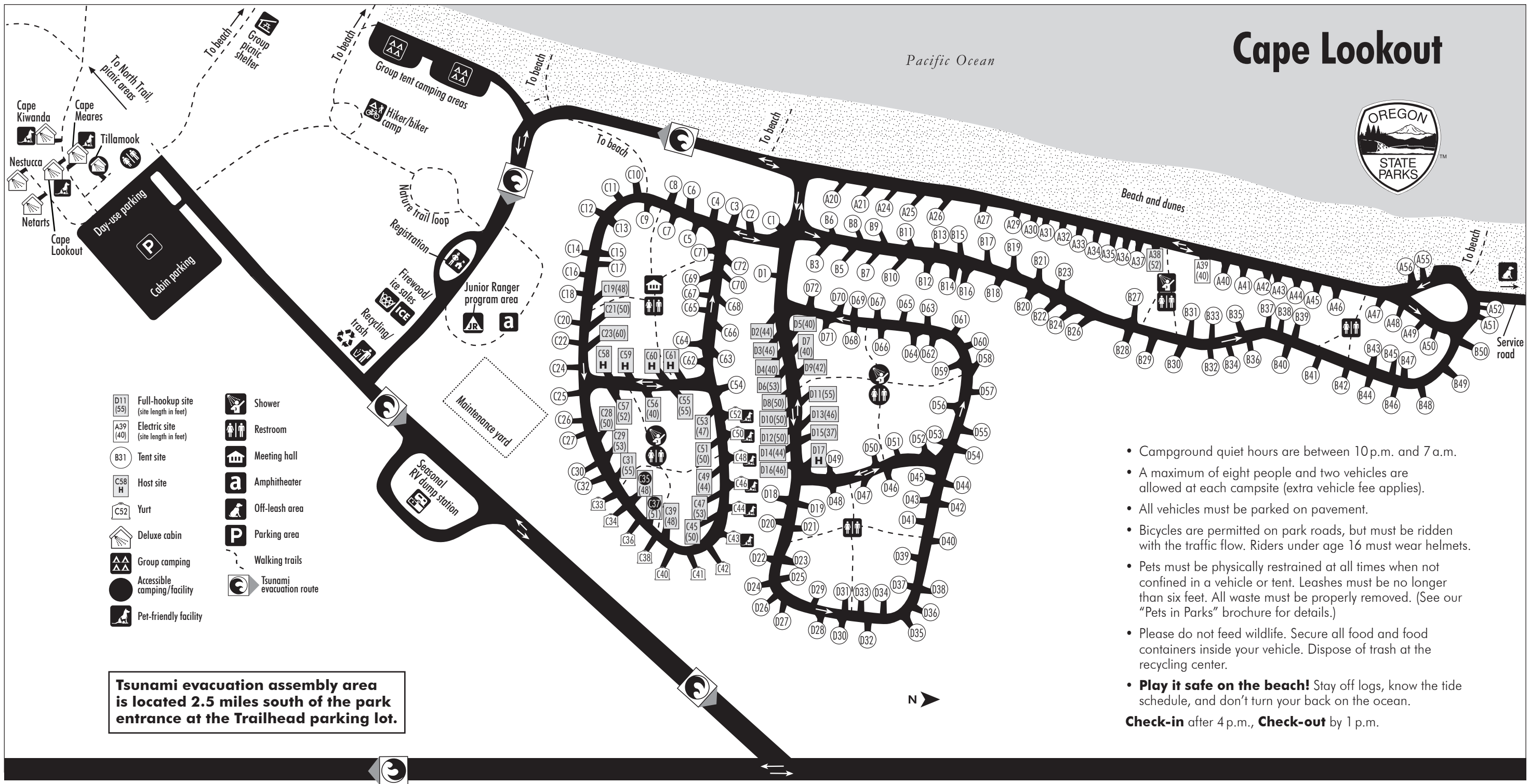

- |          |  |  |                          |
|----------|--|--|--------------------------|
| D11 (55) | Full-hookup site (site length in feet) |  | Shower                   |
| A39 (40) | Electric site (site length in feet)    |  | Restroom                 |
| B31      | Tent site                              |  | Meeting hall             |
| C58 H    | Host site                              |  | Amphitheater             |
| C52      | Yurt                                   |  | Off-leash area           |
|          | Deluxe cabin                           |  | Parking area             |
|          | Group camping                          |  | Walking trails           |
|          | Accessible camping/facility            |  | Tsunami evacuation route |
|          | Pet-friendly facility                  |  |                          |

**Tsunami evacuation assembly area is located 2.5 miles south of the park entrance at the Trailhead parking lot.**

- Campground quiet hours are between 10 p.m. and 7 a.m.
- A maximum of eight people and two vehicles are allowed at each campsite (extra vehicle fee applies).
- All vehicles must be parked on pavement.
- Bicycles are permitted on park roads, but must be ridden with the traffic flow. Riders under age 16 must wear helmets.
- Pets must be physically restrained at all times when not confined in a vehicle or tent. Leashes must be no longer than six feet. All waste must be properly removed. (See our "Pets in Parks" brochure for details.)
- Please do not feed wildlife. Secure all food and food containers inside your vehicle. Dispose of trash at the recycling center.
- **Play it safe on the beach!** Stay off logs, know the tide schedule, and don't turn your back on the ocean.

**Check-in** after 4 p.m., **Check-out** by 1 p.m.

← To Pacific City – 15 miles      To Tillamook – 11 miles →